

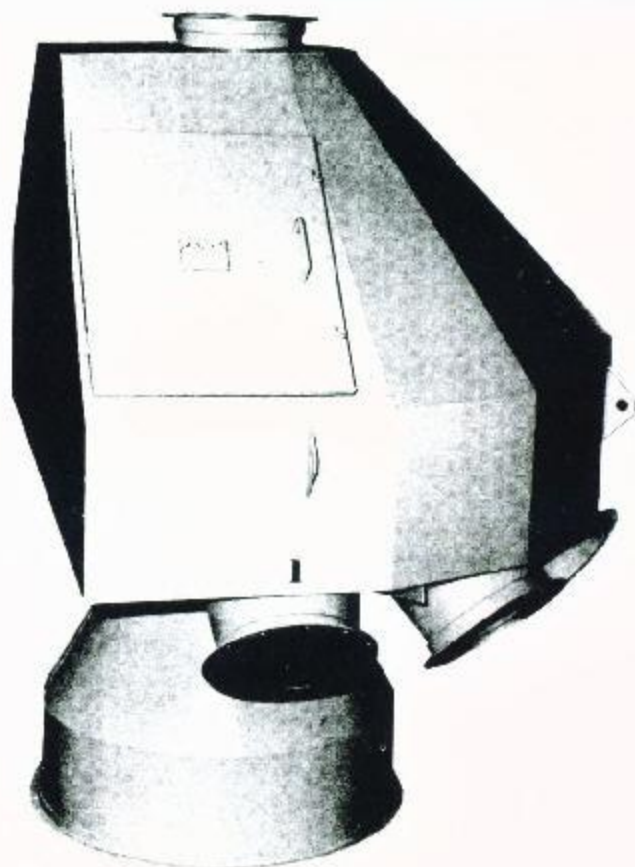

ESSMUELLER

MANUAL AND ELECTRIC FLAT-BACK DISTRIBUTORS

- AVAILABLE IN 45, 50 AND 60 DEGREE FLOW DESIGNS
- STANDARD SPOUT DIAMETERS ARE 6, 8, 10, 12, 14 AND 16 INCHES
- ABRASION-RESISTANT STEEL TURNPOUT ASSURES LONG LIFE
- UP TO 17 OUTLET STATIONS ARE AVAILABLE AS STANDARD
- WEATHER-TIGHT CONSTRUCTION REDUCES CONTAMINATION



- ACCESS DOORS PROVIDE EASY INSPECTION AND MAINTENANCE
- SEALS AND LINERS CAN BE FURNISHED
- SPECIAL DESIGNS ARE POSSIBLE

standard flange drilling

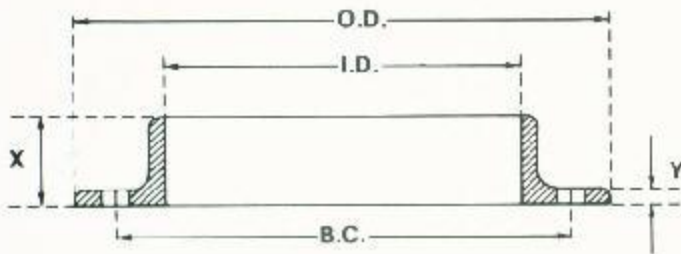

Normal Size, Inches	Actual Inside Diameter, Inches I.D.	Outside Diameter Inches O.D.	X	Y	Bolt Circles, Inches B.C.	Holes	
						Bolt Size In.	Number
6	6 $\frac{1}{8}$	8 $\frac{3}{8}$	1 $\frac{1}{8}$	$\frac{1}{8}$	7 $\frac{1}{2}$	$\frac{1}{2}$	6
8	8 $\frac{1}{8}$	10 $\frac{3}{8}$	1 $\frac{1}{8}$	$\frac{1}{8}$	9 $\frac{1}{2}$	$\frac{3}{16}$	8
10	10 $\frac{1}{16}$	12 $\frac{7}{16}$	1 $\frac{1}{8}$	$\frac{1}{8}$	11 $\frac{1}{4}$	$\frac{3}{16}$	8
12	12 $\frac{3}{16}$	15 $\frac{3}{16}$	1 $\frac{1}{2}$	$\frac{3}{16}$	13 $\frac{3}{16}$	$\frac{3}{8}$	12
14	14 $\frac{3}{8}$	17 $\frac{3}{8}$	1 $\frac{1}{2}$	$\frac{3}{16}$	15 $\frac{3}{16}$	$\frac{3}{8}$	12
16	16 $\frac{1}{4}$	19 $\frac{1}{4}$	1 $\frac{1}{2}$	$\frac{3}{16}$	18 $\frac{1}{4}$	$\frac{3}{8}$	16

electric remote control panel

Provides simple, push-button remote control from any area in your plant. Entire dust-tight panel, including starter for motor, prewired for fast, easy installation.

Features easy-to-read dial for positioning turnspout... push-button for starting distributor... lights and label tags for each station... hinged cover for quick access if maintenance or servicing are required.

Explosion-proof panel optional.

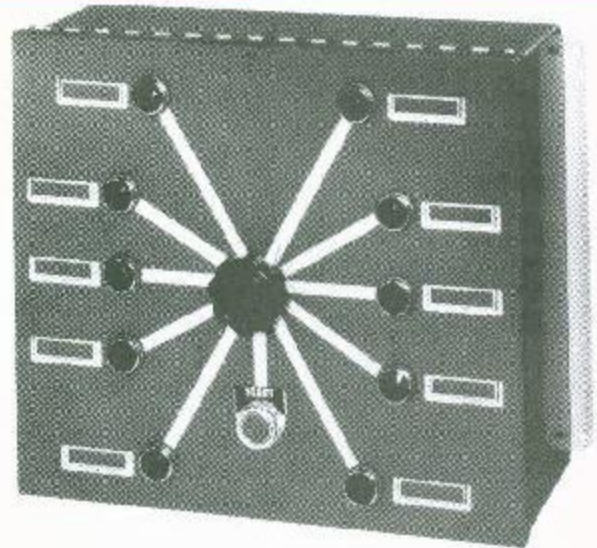

lower control stand

For use with manual turnhead, enables operator to provide positive control of the inner rotating spout from any distance by using rust-proof galvanized aircraft cable and two control devices.

A hand-operated indexing wheel rotates the inner spout. Another device, a floor-mounted foot pedal, releases the inner spout mechanism, enabling it to be turned to any of the other outlet spouts.

NOTE: Construction features and specifications subject to change without notice.

The ESSMUELLER COMPANY

P.O. BOX 1986, LAUREL, MISSISSIPPI 39441-1936

PHONE: TOLL-FREE 1-800-325-7175 • IN MISSISSIPPI: 1-601-649-0039

FAX: 601-649-4320

www.essmueller.com

